

## Proprietary Ramp

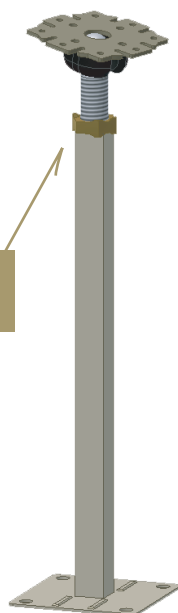
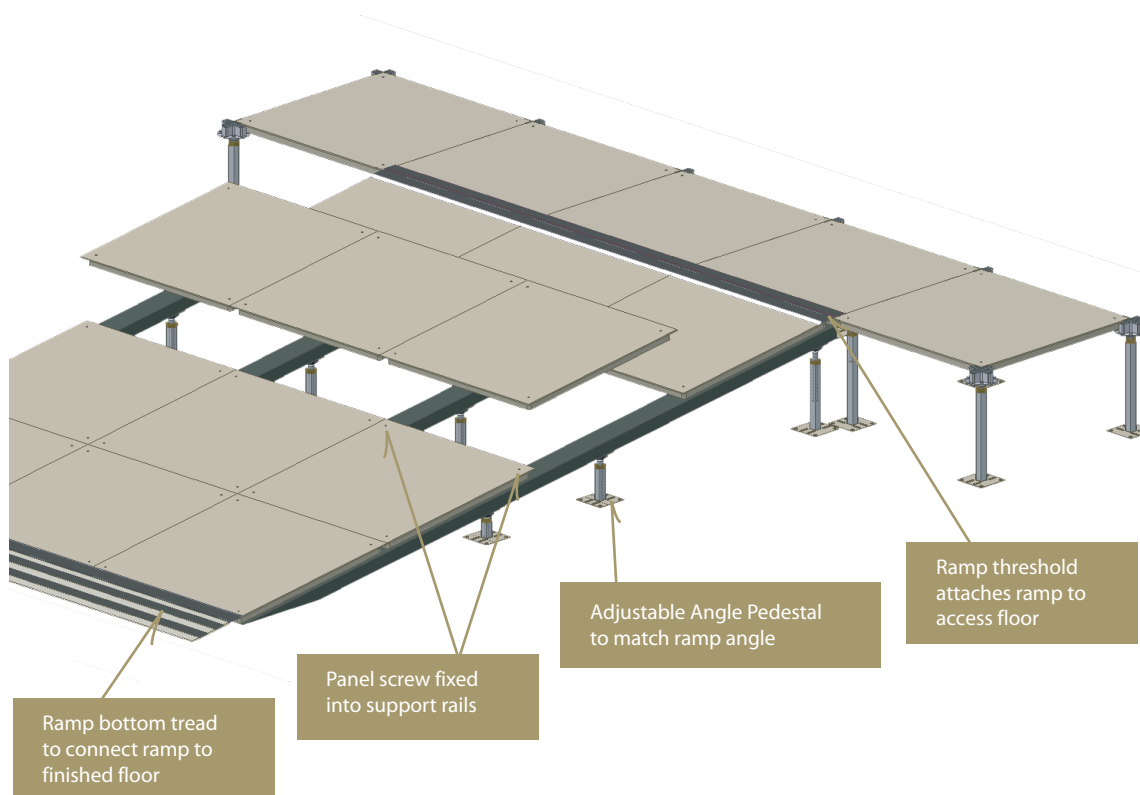

S10 Adjustable Angle Pedestal

### Ramp Building Recommendations

#### Ramp Slope:

1. A slope no greater than 1:8 when under 1.5m long, or 1:14 if between 1.5m and 9m long.
2. A landing at the top that is 1m wide by 1.33m long for ramps with a 1:8 slope, or 1.2m long for a 1:14 ramp slope.
3. A smooth transition to their landings and adjoining walkways.

#### Ramp Size:

Ramp width should be in 600mm increments, therefore allowing for the use of a full panel.

#### Application:

This system has been designed to be used in conjunction with our SC/WF bare panel series only.

Adjustable angle pedestal allows for supports to be placed along the ramp to comply with loading requirements. The S10 adjustable angle pedestal allows the installer to set the angle to meet the ramp design requirements.